

SHARED CURRENTS | WHERE PEOPLE AND NATURE FLOW TOGETHER

SHARED CURRENTS | WHERE PEOPLE AND NATURE FLOW TOGETHER

LANDSCAPES HOLD WONDROUS POWER – THEY CONNECT HUMAN AND NON-HUMAN WORLDS, CARRYING THE STORIES OF TIME, CHANGE, AND RENEWAL. THE CONFLUENCE OF CARE DRAWS ON THAT POWER TO REIMAGINE THE SAINT PAUL RIVERFRONT AS A REGENERATIVE TERRAIN WHERE ARCHITECTURE, ECOLOGY, AND COMMUNITY MERGE INTO ONE LIVING SYSTEM.

HERE, THE MISSISSIPPI IS NOT A BACKDROP BUT A NARRATOR. ITS FLOOD LINES, SEDIMENT PATTERNS, AND SHIFTING EDGE SHAPE THE PROJECT'S STEEP GREEN ROOFS, CARVED TERRACES, AND BRAIDED PATHWAYS – EACH ECHOING THE RIVER'S NATURAL INTELLIGENCE. THE DESIGN LISTENS TO THE RIVER'S RHYTHMS, ALLOWING WATER, PEOPLE, PLANTS, AND WILDLIFE TO MOVE TOGETHER ACROSS THE SITE.

A REGENERATIVE RIVERFRONT

RATHER THAN RESISTING CHANGE, THE LANDSCAPE EMBRACES IT. SLOPED GREEN ROOFS CAPTURE STORMWATER AND SEED DISPERSAL. TERRACED FLOODPLAINS COLLECT SILT AND NOURISHMENT. MARKET GARDENS, POLLINATOR MEADOWS, AND SHELTERED MICROCLIMATES RESTORE SOIL HEALTH AND BIODIVERSITY. INDOOR-OUTDOOR GREENHOUSES EXTEND THE GROWING SEASON, STRENGTHENING FOOD ACCESS AND CLIMATE RESILIENCE.

A CIVIC LANDSCAPE OF CARE

THE CARVED AMPHITHEATERS BECOME SPACES FOR PERFORMANCE, REFLECTION, AND PUBLIC GATHERING – LARGE ENOUGH FOR FESTIVALS, INTIMATE ENOUGH FOR QUIET DAILY USE. CIRCULAR OCELLUS WINDOWS PIERCE THE CANYON WALLS, SCATTERING SHIFTING DAYLIGHT INTO LEARNING SPACES BELOW. THE ELEVATED RIDGE PATHS FORM A CONTINUOUS PUBLIC PARK LINKING DOWNTOWN TO THE WATER'S EDGE.

FOR YOUTH, THE SITE BECOMES A PLACE OF EXPLORATION – CLIMBING, RUNNING, AND DISCOVERING NEW ECOLOGICAL WORLDS EMBEDDED IN THE ARCHITECTURE.

FOR ELDERLY, IT OFFERS SHELTERED OVERLOOKS AND GENTLE SLOPES THAT RECONNECT THEM TO THE RIVER THAT SHAPED THE CITY.

FOR WILDLIFE, IT CREATES HABITAT CORRIDORS WOVEN INTO THE PARK'S VERY STRUCTURE.

THE PROJECT TRANSFORMS THE MISSISSIPPI FROM AN EDGE INTO A LIVING CENTER – A REGENERATIVE CORE FOR COMMUNITY, ECOLOGY, AND FUTURE GENERATIONS. THROUGH EMPATHY AND DESIGN, THE CONFLUENCE OF CARE BECOMES A LANDSCAPE WHERE WATER TEACHES RESILIENCE, SOIL CARRIES MEMORY, AND ARCHITECTURE UPLIFTS THE SHARED LIFE OF THE CITY.

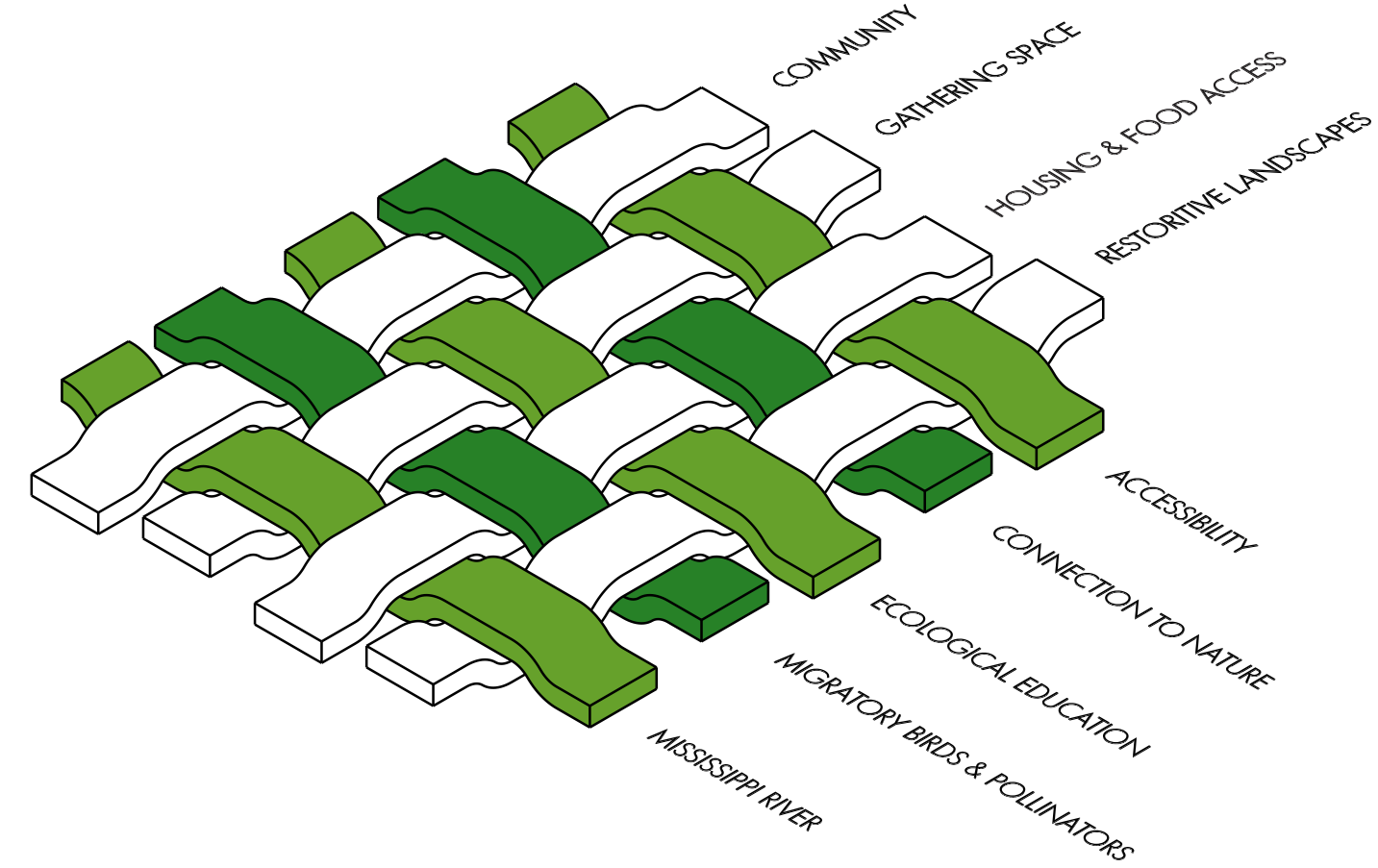

CONCEPT DIAGRAM- WEAVING LANDSCAPE, ARCHITECTURE AND COMMUNITY

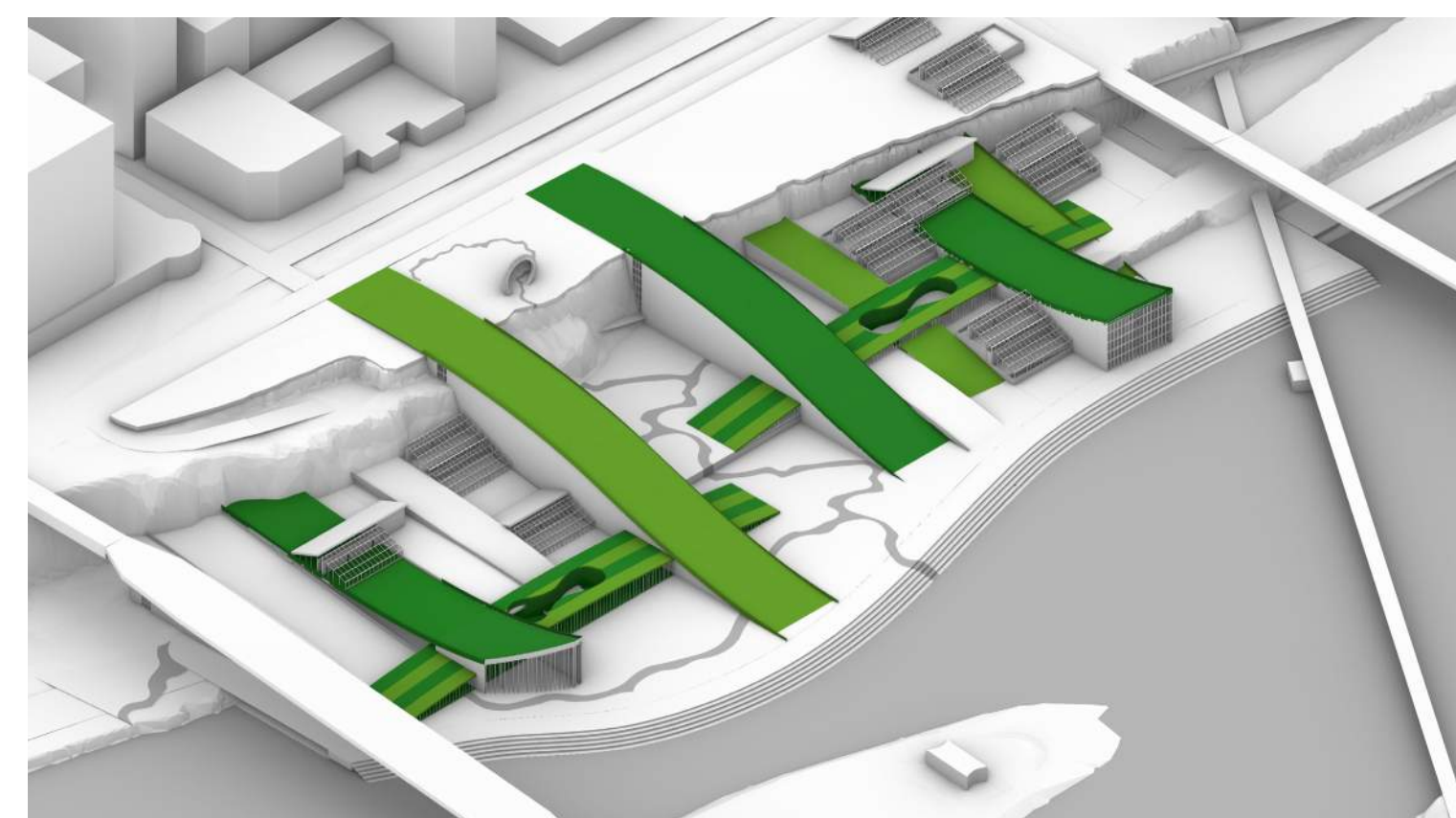

CONCEPT DIAGRAM – RIVER PROJECTION. THE RIVER'S FORM IS LITERALLY PROJECTED INTO THE LANDSCAPE, CARVING PATHWAYS THAT GUIDE PEOPLE FROM THE CITY DOWN TO THE WATERFRONT.

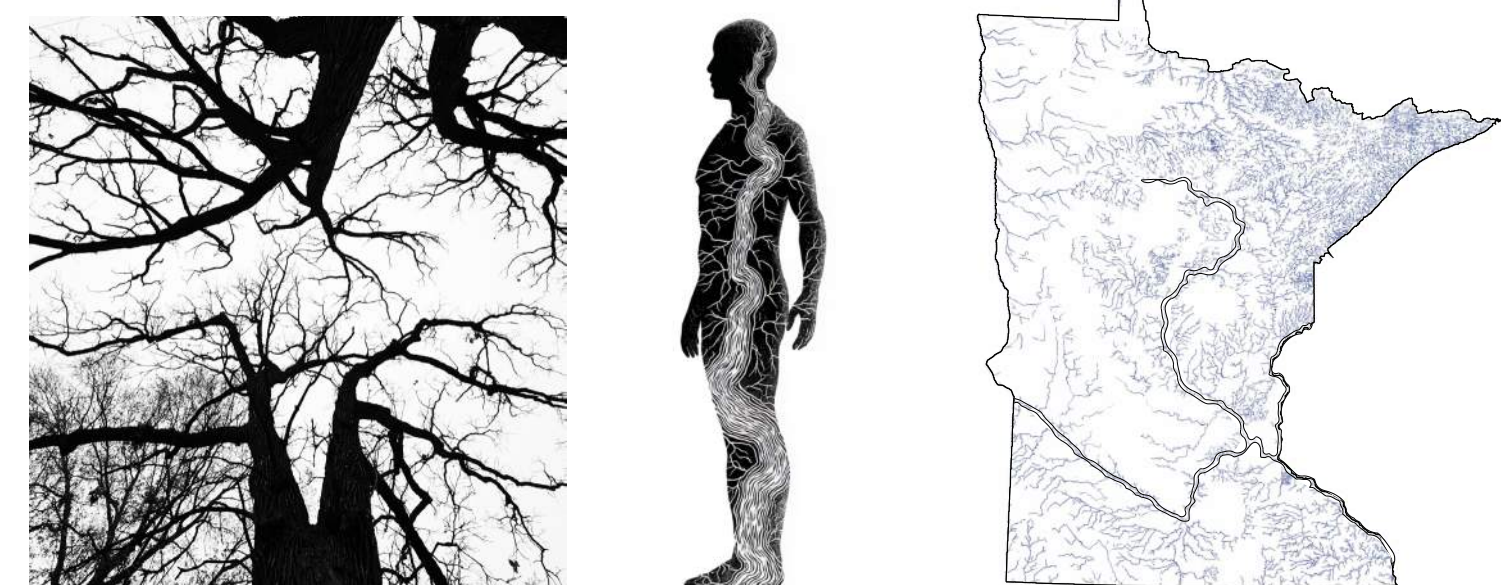

CONCEPT DIAGRAMS – MAPPING SHARED SYSTEMS: RIVERS, VEINS, AND THE FLOW OF PEOPLE (CENTER HUMAN IMAGE WAS AI GENERATED)



- 1. UPPER TERRACE / URBAN EDGE
EXISTING NEIGHBORHOOD FABRIC
PRIMARY PEDESTRIAN + VEHICULAR STREET
GREEN BOULEVARD BUFFER
- 2. BLUFFS / RIVERBANK FORM
CARVED SANDSTONE BLUFF EDGE
RESTORED PRAIRIE + POLLINATOR MEADOW
TOPOGRAPHIC SPILL / EROSION-INSPIRED
- 3. CENTRAL COMMUNITY SPINE
SHARED CURRENTS WALK
(RIVER FORM PROJECTED INTO SITE)
SEASONAL WET MEADOW ZONES
- 4. PROGRAM BARS (ARCHITECTURE)
COMMUNITY WORKSHOP HALL
NATURE CENTER
SUSTAINABLE HOUSING
RESTAURANTS
- 5. COURTYARDS + MICRO-HABITATS
FOREST COURTYARD (SHADE, BIODIVERSITY)
PLAY COURTYARD (LOOSE PARTS, NATURE PLAY)
GARDEN COURTYARD (COMMUNITY PLANTING BEDS)
- 6. LOWER RIVER TERRACE
RIVER ACCESS PLATEAUS
ART FAIRS
FARMERS MARKETS
PERFORMANCE
- 7. RIVERFRONT CONNECTION
KAYAK / CANOE ACCESS NODE
STAIRCASE TO THE WATERFRONT

SITE PLAN | SHARED CURRENTS



SITE SECTION

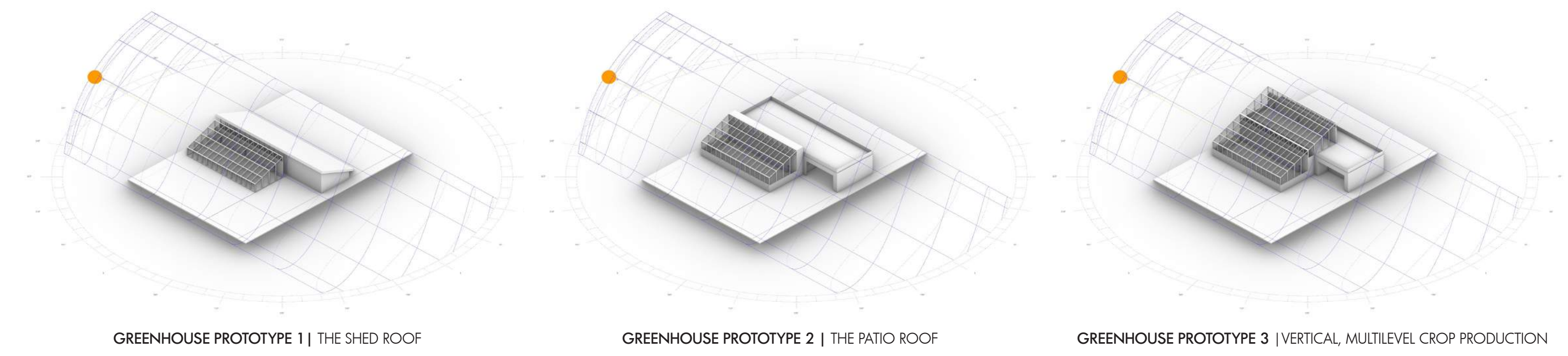

GREENHOUSE PROTOTYPE 1 | THE SHED ROOF GREENHOUSE PROTOTYPE 2 | THE PATIO ROOF GREENHOUSE PROTOTYPE 3 | VERTICAL, MULTILEVEL CROP PRODUCTION

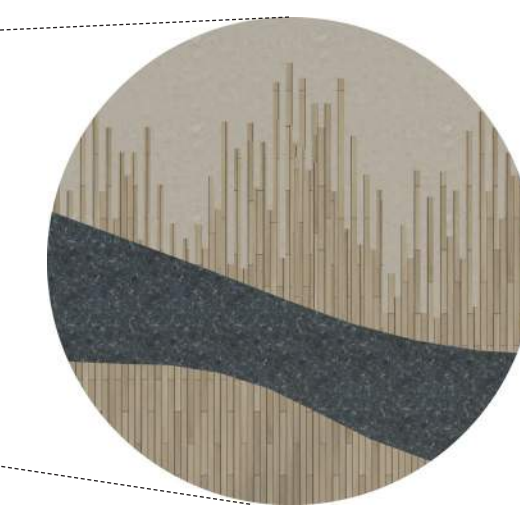
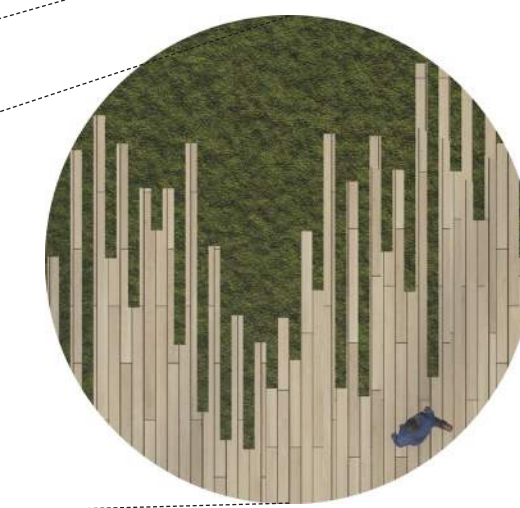
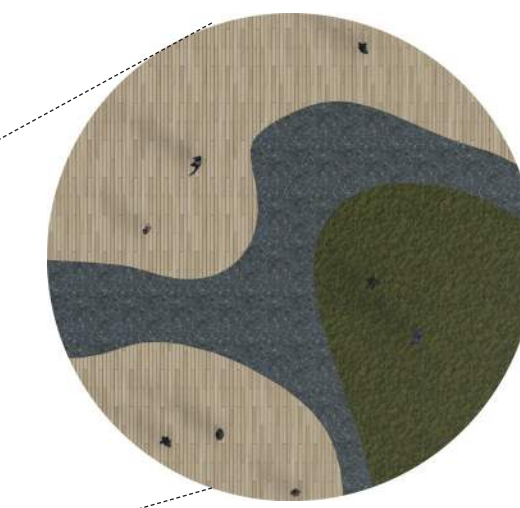
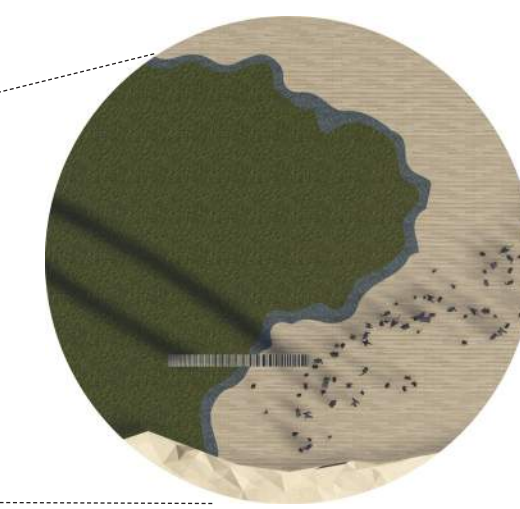

A COMMUNITY-FOCUSED GREENHOUSE ROOTED IN BIOPHILIC DESIGN



SOUTHERN SUN EXPOSURE WITH EXPANSIVE VIEWS OVER THE RIVER VALLEY



YEAR-ROUND FRUIT AND VEGETABLE CROPS TO HELP MITIGATE FOOD DESERTS



BIOPHILIC DESIGN SUPPORTS HUMAN HEALTH AND WELL-BEING

NORTHERN GREENHOUSE | PROTOTYPE DESCRIPTION

THE NORTHERN GREENHOUSE HOUSE IS A HYBRID STRUCTURE—HALF GREENHOUSE, HALF DWELLING—DESIGNED TO SUPPORT YEAR-ROUND FOOD PRODUCTION AND DEEP BIOPHILIC LIVING IN MINNESOTA'S HARSH CLIMATE. A HIGHLY INSULATED, COMPACT HOME SITS INSIDE A LARGER POLYCARBONATE GREENHOUSE SHELL, CREATING A WARM THERMAL BUFFER WHERE RESIDENTS CAN GROW FRUITS, VEGETABLES, AND SMALL ORCHARD TREES EVEN IN MID-WINTER.

THE GREENHOUSE ISN'T JUST FUNCTIONAL, IT'S THE PROJECT'S EMOTIONAL CORE. THE BUFFER ZONE BECOMES A DAILY BIOPHILIC ENCOUNTER—MORNING LIGHT WARMING CITRUS LEAVES, SOIL BEDS THAT STAY ALIVE THROUGH FEBRUARY, AND A PROTECTED WINTER GARDEN WHERE PEOPLE EXPERIENCE THE SENSORY RICHNESS OF PLANTS, WARMTH, AND CHANGING SEASONS WITHOUT LEAVING SHELTER. THE DWELLING OPENS ONTO THIS INNER LANDSCAPE WITH SLIDING DOORS AND OPERABLE WINDOWS, LETTING NATURE BECOME PART OF EVERYDAY CIRCULATION. THE GREENHOUSE LAYER IS SIZED TO MAINTAIN ABOVE-FREEZING TEMPERATURES EVEN ON WINTER NIGHTS, WITH PASSIVE SOLAR GAIN SUPPLEMENTED BY LOW-ENERGY RADIANT LOOPS OR COMPOST-HEAT BENCHES. INSIDE, RESIDENTS CAN GROW DWARF APPLE, PEACH, FIG, AND CITRUS TREES, BERRY SHRUBS SUCH AS BLUEBERRIES AND RASPBERRIES, COLD-TOLERANT GREENS (KALE, SPINACH, CHARD), VINING SUMMER CROPS (TOMATO, CUCUMBER) THAT EXTEND WELL PAST TYPICAL FROST DATES, RAISED SOIL BEDS LINE THE PERIMETER, TRELLISES CLIMB THE GREENHOUSE FRAME, RAINWATER IS CAPTURED, FILTERED, AND REUSED FOR IRRIGATION.

A KEY FEATURE OF THE ROOF IS AN AUTOMATIC VENT FLAP THAT OPENS WHENEVER TEMPERATURES INSIDE EXCEED 68°F, USING A PASSIVE WAX-PISTON ACTUATOR TO RELEASE HEAT AND KEEP THE MICROCLIMATE STABLE.

BY MERGING HOME AND GREENHOUSE, THE PROTOTYPE TURNS THE NECESSITIES OF MINNESOTA LIVING—SUN, SHELTER, WARMTH—INTO A REGENERATIVE SYSTEM WHERE BIOPHILIA ISN'T AN AMENITY BUT THE ORGANIZING PRINCIPLE OF THE ARCHITECTURE.

SHARED CURRENTS | WHERE PEOPLE AND NATURE FLOW TOGETHER



CONCEPT DIAGRAMS — MAPPING SHARED SYSTEMS: RIVERS, VEINS, AND THE FLOW OF PEOPLE



FRAMED GATEWAY - A CRAFTED FRAME THAT DRAWS THE EYE DOWN THE SLOPE AND INTO THE RIVER VALLEY



FRAMED GATEWAY - SEASONAL CHANGE



PERSPECTIVE — GREEN ROOFS RESTORING MINNESOTA'S NATIVE LANDSCAPE AND SUPPORTING POLLINATORS AND MIGRATORY SPECIES



AXON — HIGHLIGHTING THE PROJECTED DRY RIVERBED PATHWAYS INSPIRED BY THE CONFLUENCE OF THE MISSISSIPPI, ST. CROIX, AND MINNESOTA RIVERS



PERSPECTIVE — WHERE GATHERING MEETS AN ACCESSIBLE TRAIL, GUIDING VISITORS DOWN TOWARD THE RIVER