

COMMUNITY-BASED. HEALTH. EQUITY. WILLMAR CENTER FOR WHOLE HEALTH

Community-Based Health Equity includes equal access to:



Identifying Downtown Willmar's existing health equity assets:



Opportunity for *Center for Whole Health* to address Connections to Nature and Environmental Health in Downtown Willmar:



With a focus on nature, how can the new Center act as a central hub for improving Whole Health?



View from Litchfield Avenue: The Center for Whole Health should feel safe, open, welcoming, uplifting, and regenerative no matter your religion, race, or socioeconomic background.



Electric Car charging and Rest Stop along Hwy. 12 and Litchfield Avenue (on former site of parking lot and gas station)

Wood floor structure over pile foundations to minimize site disturbance, limit carbon-intensive use of concrete, and increase ability to add, remove, and modify structures over time

Restored Native Habitat with Apple Orchard

Local lumber structure with reclaimed wood barn siding

Sun Shading and Solar Collection Device

Informational Signage for increasing awareness of holistic care

Simple expression to conserve resources and decrease cost of individual buildings over time

Reflecting pool and native grasses serve as a source of spiritual and mental renewal while doubling as a rainwater filtration/bioretenion pond

Prioritized south facing triple-pane low-E glass shaded by trellis in summer

Bike racks to encourage exercise and green transit

Central Geothermal Well and Mechanical with Distributed Infrastructure as teaching tool about environmental science

Increasing resiliency to climate change: thick insulation and strategic window openings; structures mainly stretched east-west to orient towards southern sun

Minimal glazing on north, west, and east facades to minimize heat loss and unwanted solar gains

Transit Stop to encourage site access and mass transportation

Walking/running trails



ADAPTABLE AND RESILIENT OVER TIME

1. Central Hub: Solar Garden Pavilion with Car Charging Stations



2. Essential Services: Energy, Food, and Central Mechanical



3. Add/Remove/Modify In Response to Climate and Program Needs



DIAGRAM / FLOOR PLAN LEGEND

A. Litchfield Avenue B. Hwy 12 C. Existing Railroad 01. Bioretention Reflecting Pond 02. Boardwalk with Trellis and Solar Collector Above 03. Litchfield Avenue Entry 04. Native Prairie 05. Apple Tree Orchard 06. Central Mechanical Environmental Learning Lab 07. Classroom/Tutoring 08. Community Dining 09. Community Kitchen 10. Counsel/Exam 11. Exhibit 12. Event/Performance 13. Fitness Gym 14. Nursery/Childcare 15. Office(s) 16. Central Telecom 17. Copy/Storage 18. Loading Access Drive 19. Distributed Mechanical/Electrical 20. Phone/Conference 21. Receiving/Storage 22. Reception/Waiting 23. Restroom(s) Gender Neutral 24. Storage 25. Vestibule

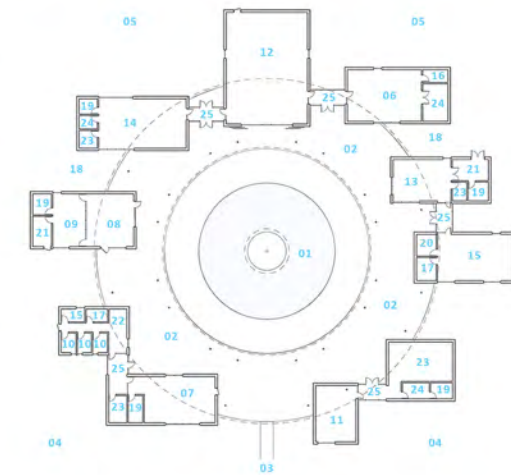

FLOOR PLAN