



- 01 YOUTH CONNECTION & DEVELOPMENT CENTER
- 02 AFRICAN DEVELOPMENT CENTER OF MN
- 03 JONES & PATOCK PA, LAW FIRM
- 04 BOTAN LOGISTICS, INC.
- 05 BIH'S SHOP OF AFRICAN FOOD

- 06 NORTH RISK PARTNERS, INSURANCE AGENCY
- 07 LIEDMAN JAY, ATTORNEY
- 08 428 LITCHFIELD AVENUE SW, STOREFRONT
- 09 FAAFAN RESTAURANT
- 10 KANDICOMP COMPUTER SERVICES

- 11 410 LITCHFIELD AVENUE SW, STOREFRONT
- 12 LAKES AREA REALTY
- 13 WEST CENTRAL DRIVING SCHOOL
- 14 INTERIOR DESIGN STUDIO & GALLERY
- 15 POTATO EATERS GALLERY

- 16 SECURITY COIN & PAWN SHOP
- 17 JAKE'S PIZZA
- 18 POTPOURRI HEALTH FOODS
- 19 CAPITOL LIEN
- 20 KWIK TRIP CONVENIENCE STORE

This proposal aims to foster the holistic health of the community through the lens of the Living Community Principles of the 21st Century Development Matrix, developed by the AIA Minnesota Center for Sustainable Building Research. This matrix identifies strategies of design and development that foster regenerative communities in seven categories: Place, Water, Health & Happiness, Materials, Equity, and Beauty.



PUBLIC PLAZA

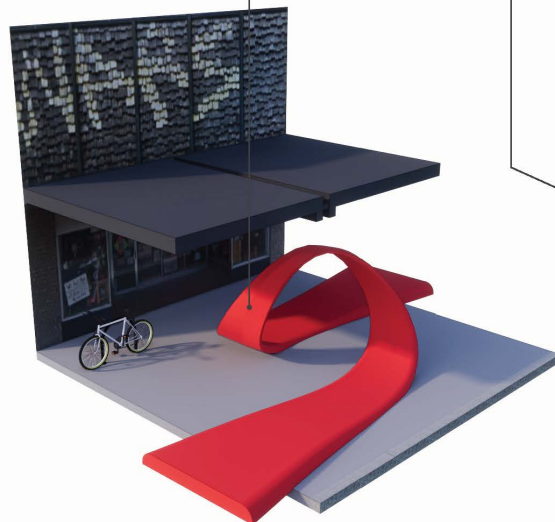

PUBLIC ART



COMMUNITY GARDEN

- 01 **EDUCATION HUB**
The secondary canopy at the west end of Litchfield Avenue serves as a way finding element and display for the features of the boardwalk to encourage meandering and human-nature connection.
- 02 **IMPROMPTU INTERACTION**
In front of the Youth Connection & Development Center a new outdoor gathering space creates a welcoming threshold for families and a place for impromptu interaction.
- 03 **OUTDOOR DINING**
A new plaza adjacent to Bih's Shop of African Food provides an opportunity for outdoor seating and dining where there was not a place for this previously.
- 04 **INNOVATIVE PUBLIC REALM**
Various biophilic environments along the path designed to include native plants, rain gardens, engaging sensory zones, and places for community gathering.
- 05 **PUBLIC ART**
Outside of the Potato Eaters Gallery is an opportunity for a public art installation. Aspects of the design are created solely for human delight and for a celebration of the local culture, spirit, and place.
- 06 **OUTDOOR MARKET**
The plaza in front of the new Center for Community Health and across the street next to Potpourri Health Foods offers space for an outdoor market in the warmer months.
- 07 **THE CENTER FOR COMMUNITY HEALTH**
This proposal is for the new Center for Community Health. In addition to community programming, this structure is designed for net-positive energy and water.
- 08 **URBAN AGRICULTURE**
The new local food program at the Center includes on-site food production and a community kitchen, contributing to the local food network and knowledge of healthy foods.
- 09 **HUMAN POWERED LIVING**
Incorporation of a new bus stop and a bike share station lessens the demand for vehicle infrastructure and advocates for human-powered transportation and pedestrian-oriented design.

SOURCES
21st Century Development Matrix
AIA MN Center for Sustainable Building Research
21stCenturyDevelopment.org

- 01 PUBLIC PLAZA
- 02 MAIN ENTRY
- 03 ASSEMBLY HALL
- 04 CLASSROOM
- 05 DAYCARE
- 06 GARDEN STORE
- 07 COMMUNITY KITCHEN
- 08 SMALL MEETING ROOMS
- 09 KITCHENETTE
- 10 OPEN OFFICE
- 11 GENDER NEUTRAL RESTROOMS

RESOURCE CANOPY
 The minimal infrastructure above the Center packs a punch, generating enough electricity for the site to be net positive. The canopy also aids in the collection of water for reuse on the site.

LEVEL TWO
 The second level houses the office space for the Center's on-site staff, while also providing small meeting rooms for use by the staff or community members.

LEVEL ONE
 The first level of the Center is a hub of activity, with a large assembly room for up to 75 people and an adjacent community classroom and daycare, open to all patrons.

COMMUNITY GARDEN
 The Center for Community Health offers a community garden with shared plots and a series of education seminars on planting. The adjacent garden store and community kitchen share the wealth of the garden with the public.

This proposal looks at what could be done for the downtown community holistically rather than through a single structure. The strategy outlined constructs as little as possible, but instead adapts the downtown core of Willmar to incorporate a place for meandering and gathering along four blocks of Litchfield Avenue SW within the historic fabric. By surrendering the parking lane of the north side of the street, this public sidewalk is extended from 12' to 20' in width, enough space to create a generous promenade.

